

## EMERGENCY ALARMS



Short Quick Blasts: **EVACUATE FAST**  
Long Slow Pace: **SHELTER IN PLACE**  
10 Second Blast: **DANGER HAS PASSED**

**Evacuate Fast** go to



**Shelter in Place** find



Contractor Maintenance Shop   
Brace Shop   
Warehouse   
Gannon Large Assembly Room  
Main Admin Bldg. Conference Rm  
AERO Electrical Bldg.

Only open during Day Shift



## EMERGENCY NUMBERS

**INTERNAL: 155**

**EXTERNAL: 813-627-2911**

- Report ALL emergencies to the phone numbers above.
- The SPO is the Incident Commander and will direct Control Room Operators to call 911 when necessary.
- Bayside Team Members are trained to respond to medical emergencies, fires, chemical spills, and confined space emergencies.

## Key Personnel Contact Information

### Control Room

Internal 72929/72829  
External (813) 627-2901/2902

### Superintendent Plant Ops

Internal 72915  
External (813) 627-2915

### Maintenance Planning

Internal 72924/72925  
External (813) 627-2924/2925

### Safety Professional

Internal 72880  
External (813) 627-2880

### Environmental Coordinator

Internal 72886  
External (813) 627-2886

### Nurse Station

**Bayside** Internal 72986  
External (813) 627-2986  
**Big Bend** Internal 56943  
External (813) 630-6943



## BAYSIDE POWER STATION

3602 Port Sutton Road  
Tampa, FL 33619



*Safety begins with  
YOU!*

**Safety Reminders**

# BAYSIDE POWER STATION KEY LOCATION MAP

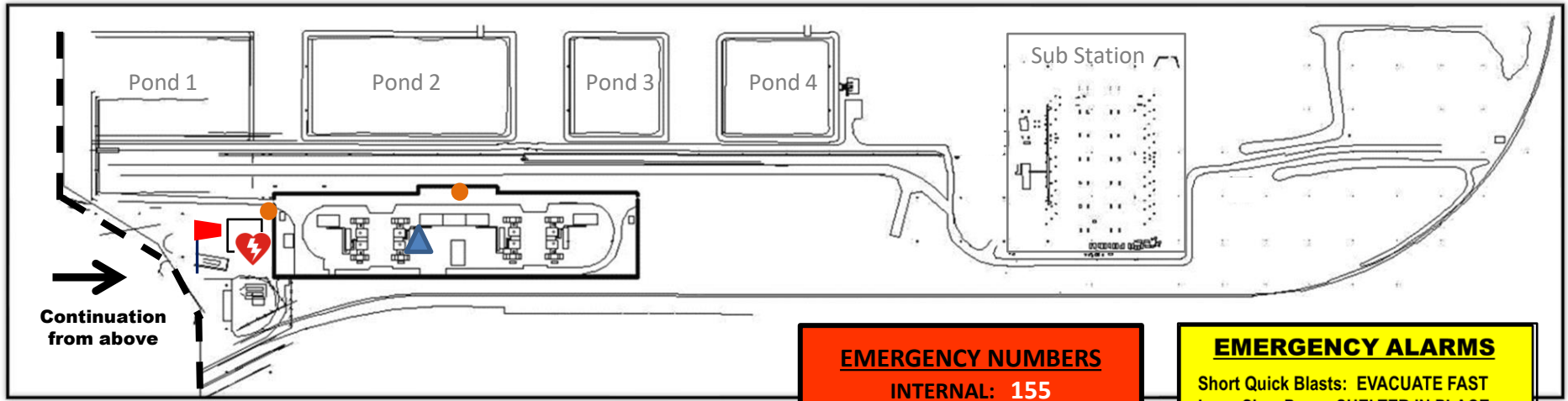
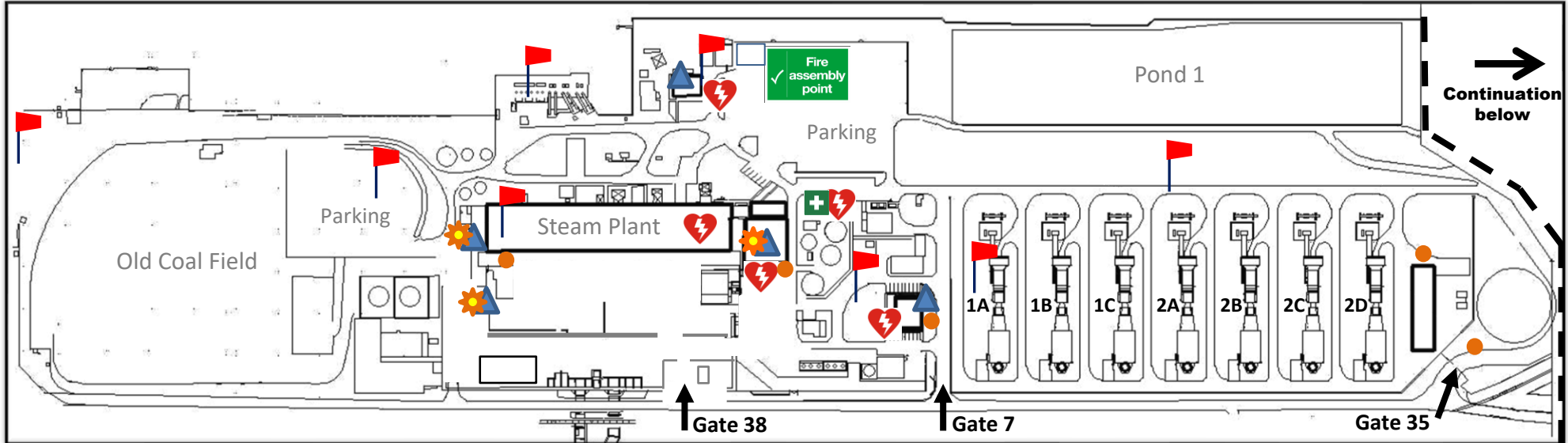

**EMERGENCY NUMBERS**  
INTERNAL: 155  
EXTERNAL: 813-627-2911

**EMERGENCY ALARMS**  
Short Quick Blasts: EVACUATE FAST  
Long Slow Pace: SHELTER IN PLACE  
10 Second Blast: DANGER HAS PASSED

**KEY LOCATIONS:**

|   |   |   |                       |   |                         |   |  |   |                      |   |   |
|---|---|---|-----------------------|---|-------------------------|---|--|---|----------------------|---|---|
|  |  |  | <b>Wind Direction</b> |  | <b>Shelter in Place</b> |  | <b>Day Shift Only Shelter in Place</b> |  | <b>Fire Assembly</b> |  | <b>Smoke in Designated Smoking Areas Only</b> |
| <b>AED</b>  | <b>First Aid</b>  |   |                       |   |                         |   |  |   |                      |   |   |